



Installation Manual

PROXIMITY CARD READER

C-300-U/H/M-BLACK

C-300-U/H/M-IVORY

 **KaDe**

WERSJA 1.0



AAT HOLDING S.A.

ul. Puławska 431, 02-801 Warszawa, tel. 22 546 05 46, faks 22 546 05 01
www.aat.pl

1. Introduction



C-300-U/H/M-BLACK

C-300-U/H/M-IVORY

Proximity card reader type C-300-U / H / M is designed for use in access control systems. It can be installed inside or outdoors. It has a housing made of ABS plastic meets the requirements of IP66 (waterproof) and tamper protection. Reader c-300-U / H / M is designed to work with controllers with Wiegand interface. The device reads the card Unique (125 kHz), HID Prox (125 KHz) and Mifare Classic (13.56 MHz). The range of the proximity card reading is from 2 to 10 cm depending on the type of card.

Characteristics reader

- For cooperation with controllers with Wiegand port
- Proximity card types - Unique and HID Prox 26 bits (125 kHz)
Mifare Classic (13.56 MHz).
- Waterproof, meets the requirements of IP66
- Built-in tamper switch the type of LDR - activates the buzzer
- Built-in sounder and optical-red / green LED
- Power supply 12 VDC

Technical specifications

Name of parameters or function	Parameters value or description
- Supply power	12 VDC +/- 10%
- Current load	< 25 mA
- Environments	For indoor and outdoor, IP66
- Operating temperature range	Od -40°C do +60°C
- Operating humidity range	10% - 95% RH
- Dimensions	103 x 48 x 20 mm
- Proximity card read range	Od 2 do 10 cm (depend of card type)
- Card Format	UNIQUE, HID Prox (125 kHz), Mifare (13,56 MHz)
- Wiegand port	D0, D1

Wiring Diagram

Red	+12V DC
Black	GND
Green	D0
White	D1
Brown	Green light-emitting diodes
Yellow	Buzzer

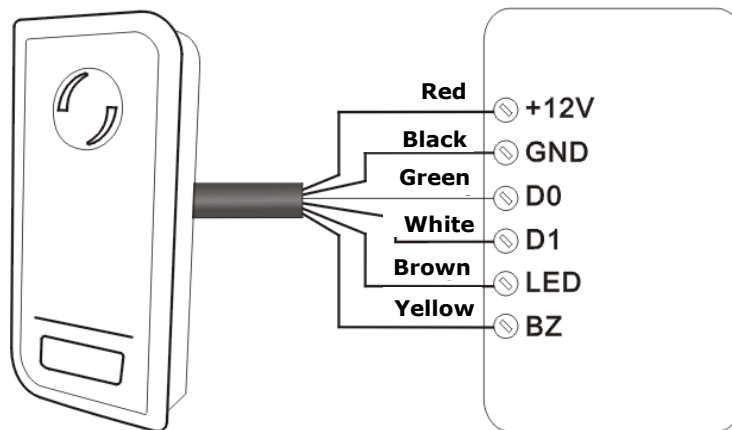

READER INSTALLATION

- ◆ Separate the back cover with holes and use as a template
- ◆ Drill 2 holes (A, C) in the wall of the bolt and one under the cable
- ◆ Insert the bolt holes (A, C) attached dowels
- ◆ Screw the rear part of the housing to the wall using the screws
- ◆ Bring out the controller cables through the hole (B)
- ◆ Mount the controller on the base and secure it from below with a special screw

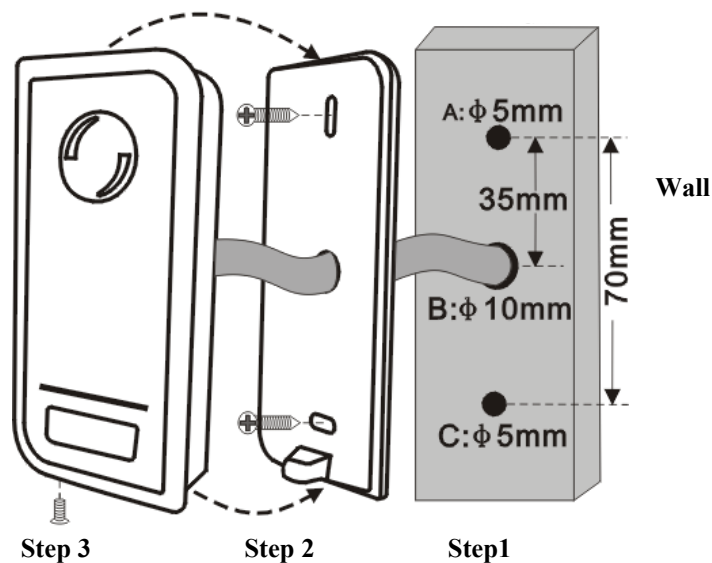



AAT HOLDING S.A.
431 Pulawska St., 02-801 Warsaw,
tel. +4822 546 05 46, fax +4822 546 05 01
www.aat.pl